

FS-TINYT insert

compatible with Tiny Towns®,
incl. the Fortune®, Villagers® and Tiny Trees® expansions



Assembly Instructions

The package contains 4 sheets, two of them are identical to the other two.

The parts marked in sheet A2 are to be discarded.

After assembly the trays are put in three layers in the original game box.

Ordinary PVA glue is required when assembling each tray.

Please make sure you dry-assemble each tray correctly before gluing it together.

Please check www.foldedspace.net for general assembly tips.

FS-TINYT

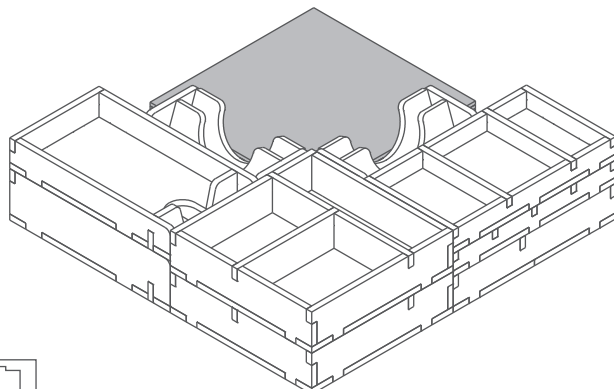

Sheet A1

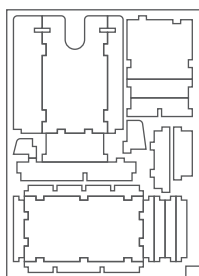

Sheet A2

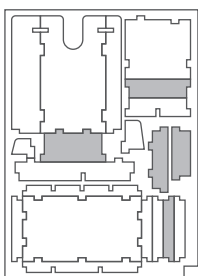

Sheet B1

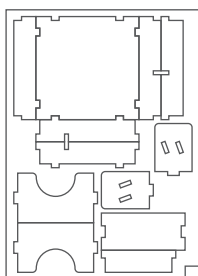

Sheet B2

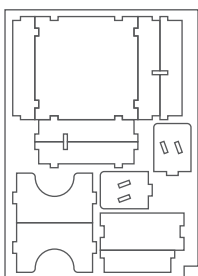

Tray 1a

Sheet A1

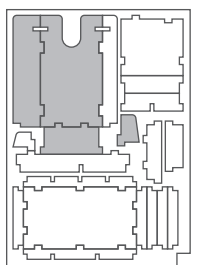

Sheet A2

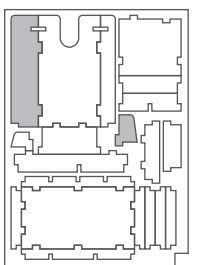

Step 1

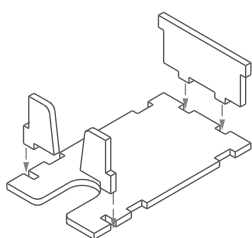

Step 2

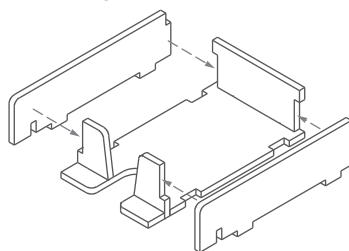

Finished tray

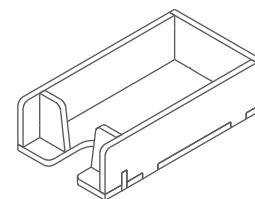

Tray 1b

Sheet A1

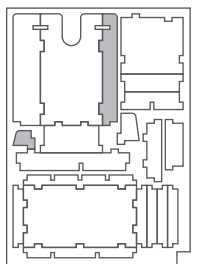

Sheet A2

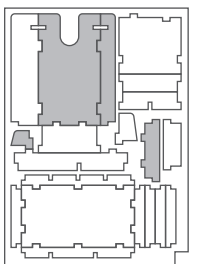

Step 1

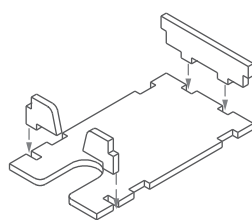

Step 2

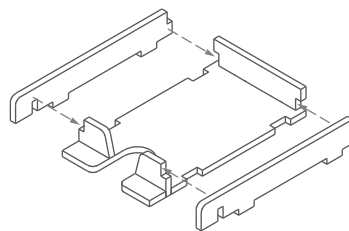

Finished tray

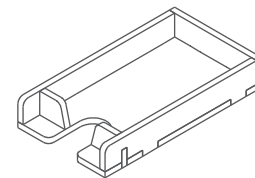

Tray 2a

Sheet A1

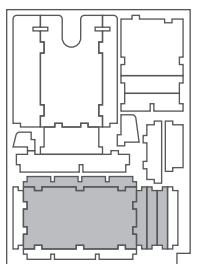

Sheet A2

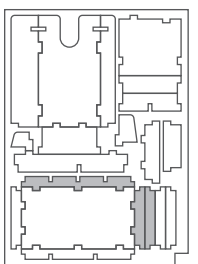

Step 1

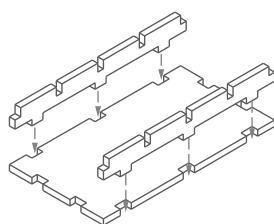

Step 2

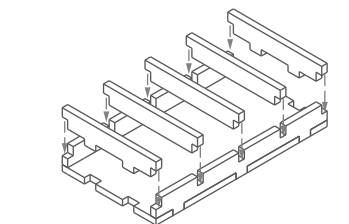

Finished tray

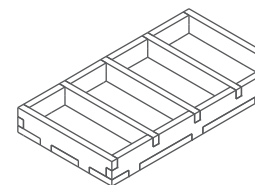

Tray 2b

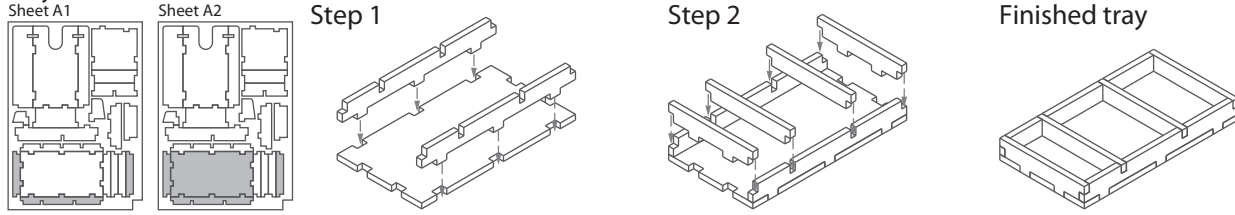

Tray 3a & 3b

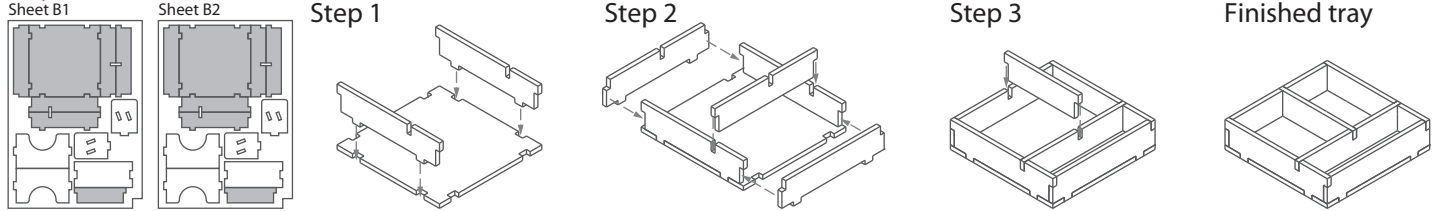

Tray 4a & 4b

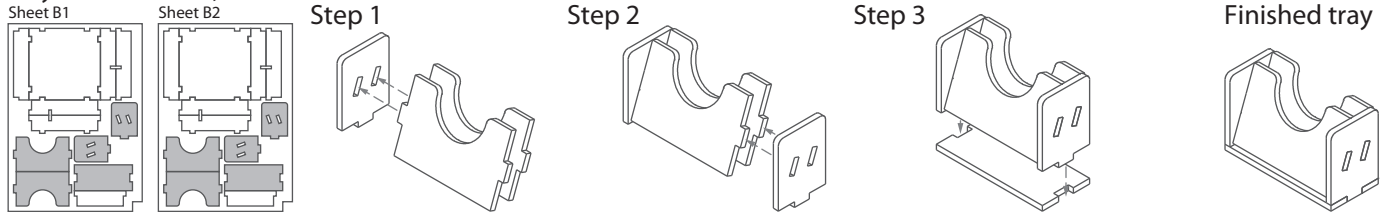

Tray 5

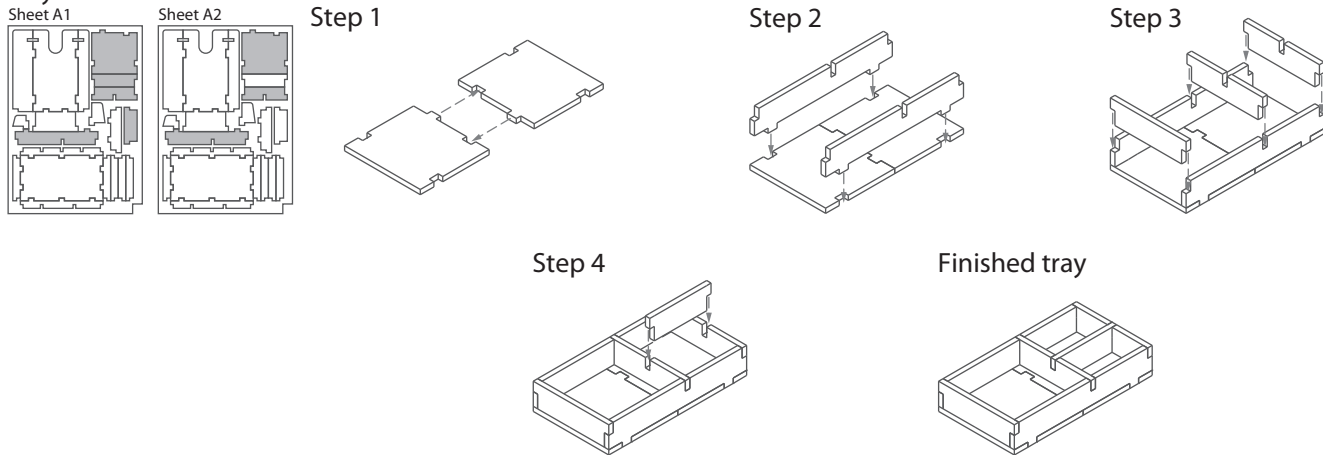

FS-TINYT

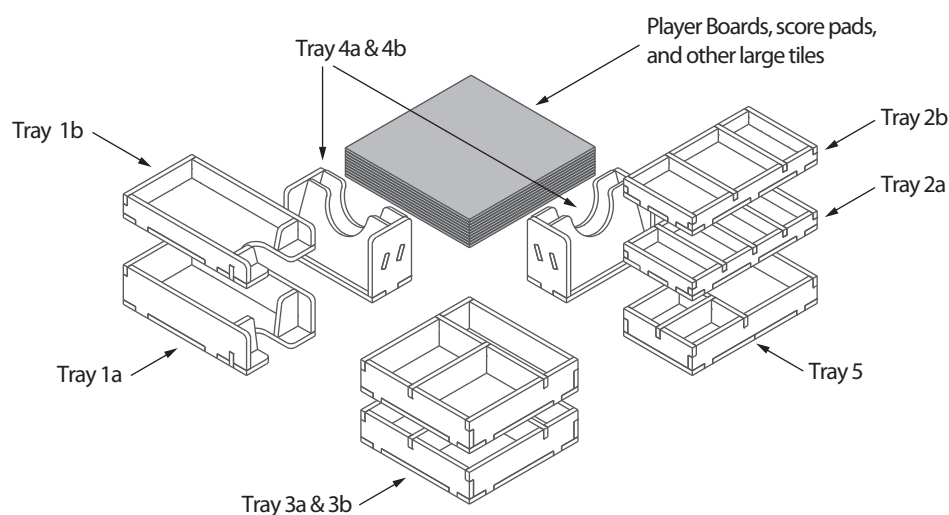

Please check www.foldedspace.net for photos of this insert in use.

Tray legend:

- Tray 1a - building cards and master builder hammer
- Tray 1b - monument cards
- Tray 2a - resource cubes
- Tray 2b - grey buildings, coins, and fifth resource cube type
- Tray 3a - blue, yellow and red buildings
- Tray 3b - green, orange and black buildings
- Tray 4a - resource cards
- Tray 4b - villager cards
- Tray 5 - villager meeple, monument buildings, and tiny trees pieces