

FS-LEGMAR insert compatible with Legendary: A Marvel Deck Building Game®, incl. space for 1,450 sleeved cards

Assembly Instructions

The package contains 4 sheets, two of them are identical to the other two.

After assembly the trays are put in single layer in the original game box.

Ordinary PVA glue is required when assembling each tray.

Please make sure you dry-assemble each tray correctly before gluing it together.

Please check www.foldedspace.net for general assembly tips.

FS-LEGMAR

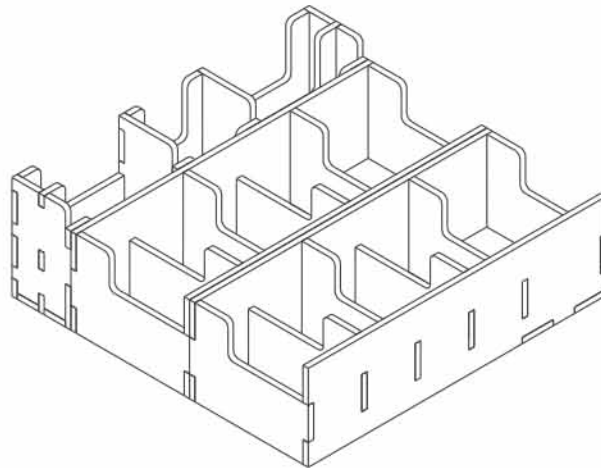

Sheet A1

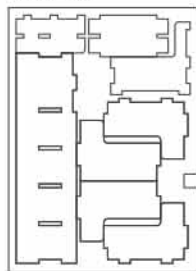

Sheet A2

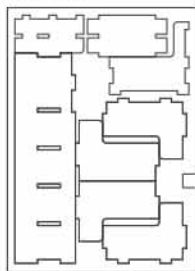

Sheet B1

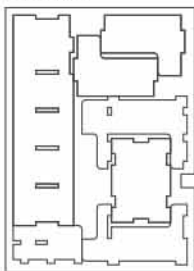

Sheet B2

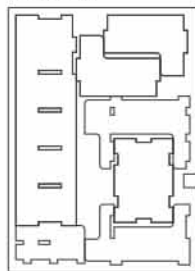

Tray 1a & 1b (the trays are identical)

Sheet A1, A2



Sheet B1, B2

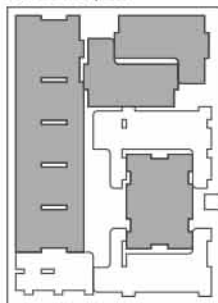

Step 1

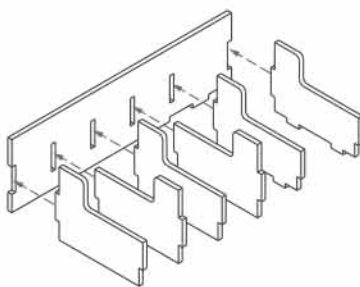

Step 2

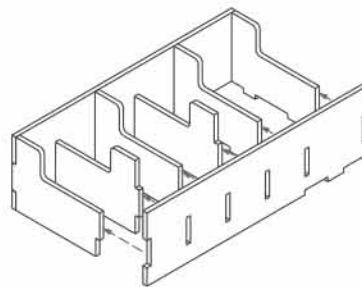

Step 3

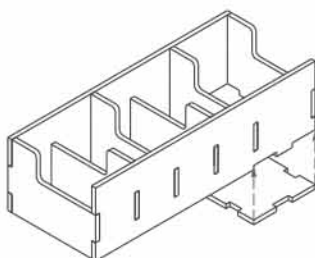

Finished tray

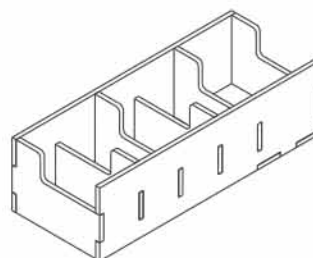

Tray 2a



Step 1

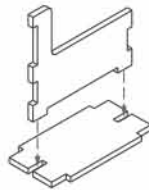

Step 2

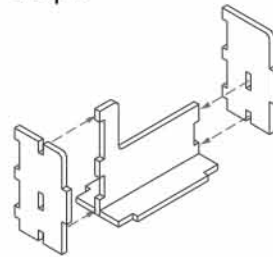

Step 3

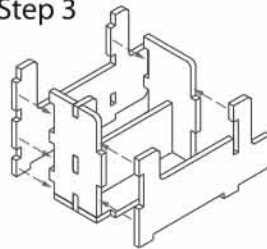

Finished tray

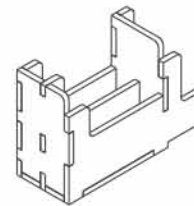

Tray 2b (the tray is a mirrored version of Tray 2a)



Step 1

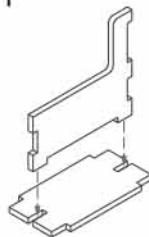

Step 2

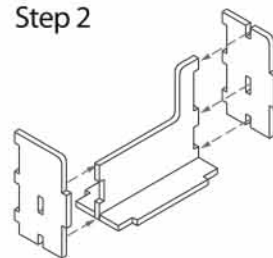

Step 3

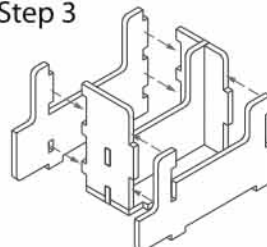

Finished tray

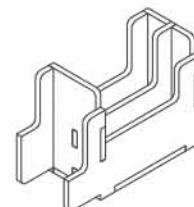

FS-LEGMAR

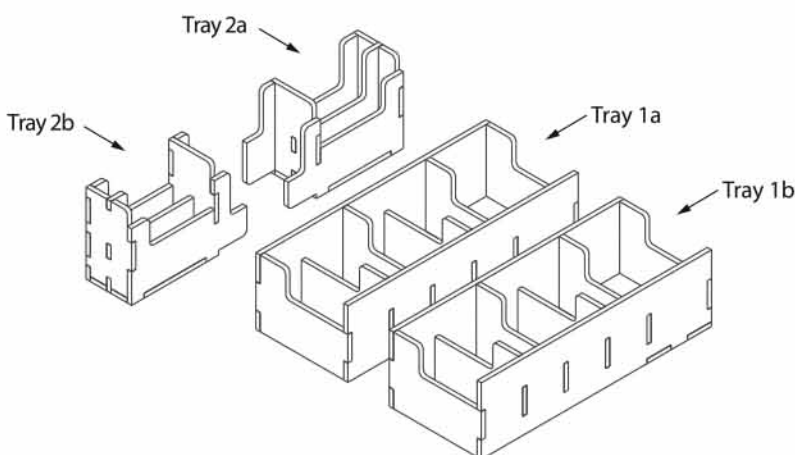

Please check www.foldedspace.net for photos of this insert in use.

Tray legend:

All trays are for storage of game cards, stored vertically, with space for the dividers from the base game. Note that there is one slot in between Trays 2a and 2b for storage of cards on their short side.

The trays can store over 1,450 sleeved cards. Note that all trays have some parts with no base, and are intended to remain in the game box.