

# FS-AEONv2 insert

compatible with Aeons End<sup>®</sup>,

including numerous expansions. Separately compatible with War Eternal<sup>®</sup>, New Age<sup>®</sup> and Outcasts<sup>®</sup> versions of the game

## Assembly Instructions

The package contains 4 sheets, two of them are identical to the other two.

The part marked in sheet A2 is to be discarded.

After assembly the trays are put in up to four layers in the original game box.

Ordinary PVA glue is required when assembling each tray.

Please make sure you dry-assemble each tray correctly before gluing it together.

The insert has two variants, with Variant 2 being for the larger Pegasus Spiele edition.

### FS-AEONv2

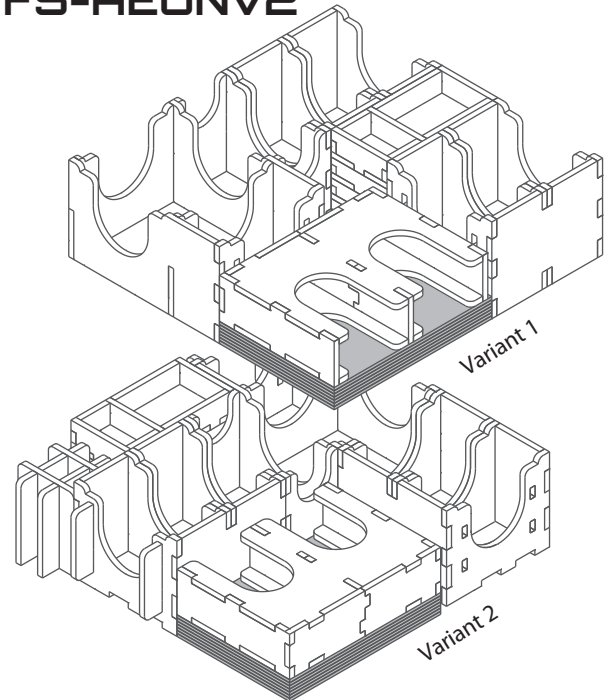

Sheet A1

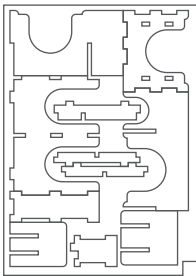

Sheet A2

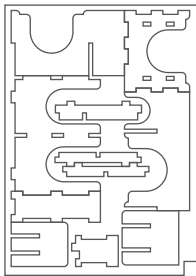

Sheet B1

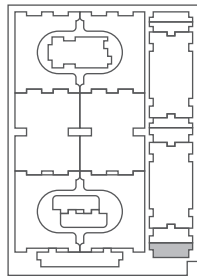

Sheet B2

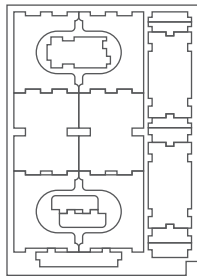

#### Tray 1v1 (the tray is only used in Variant 1)

Sheet A1

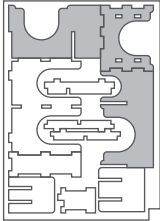

Sheet A2

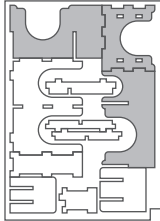

Step 1

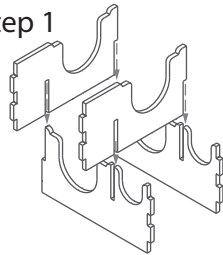

Step 2

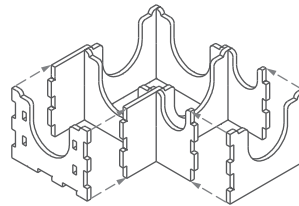

Finished tray

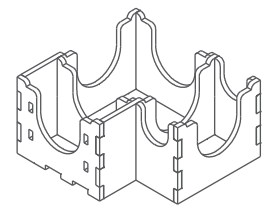

#### Tray 1v2 (the tray is only used in Variant 2)

Sheet B1

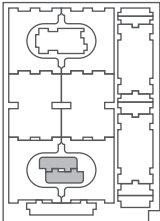

To assemble  
repeat steps 1-2  
of Tray 1v1

Step 3

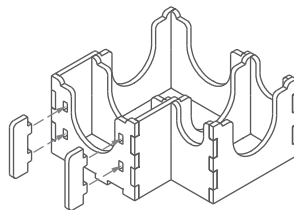

Finished tray

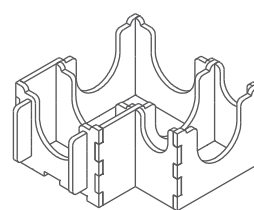

#### Tray 2av1 & 2b (tray 2av1 is only used in Variant 1)

Sheet B1

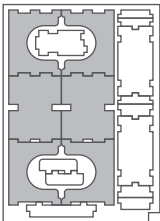

Sheet B2

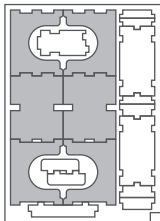

Step 1

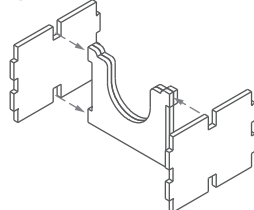

Step 2

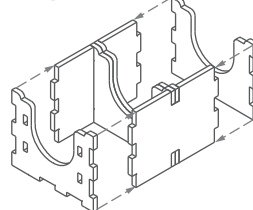

Finished tray

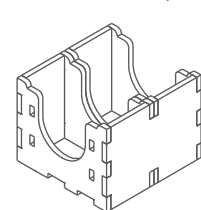

#### Tray 2av2 (the tray is only used in Variant 2)

Sheet B2

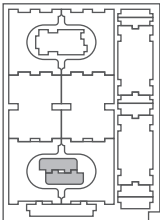

To assemble  
repeat steps 1-2  
of Tray 2v1

Step 3

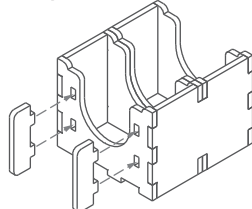

Finished tray

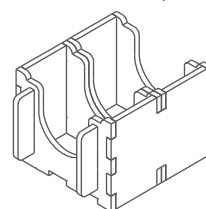

FS-AEONv2 insert compatible with Aeons End®, including numerous expansions. Separately compatible with War Eternal®, New Age® and Outcasts® versions of the game

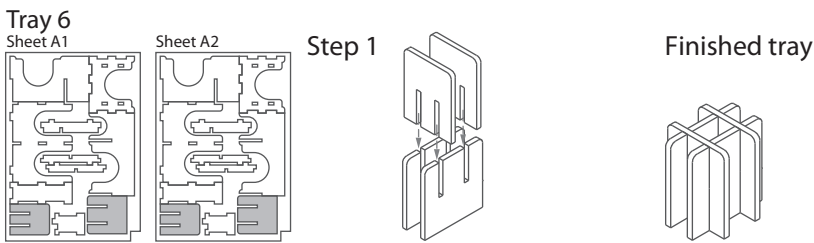
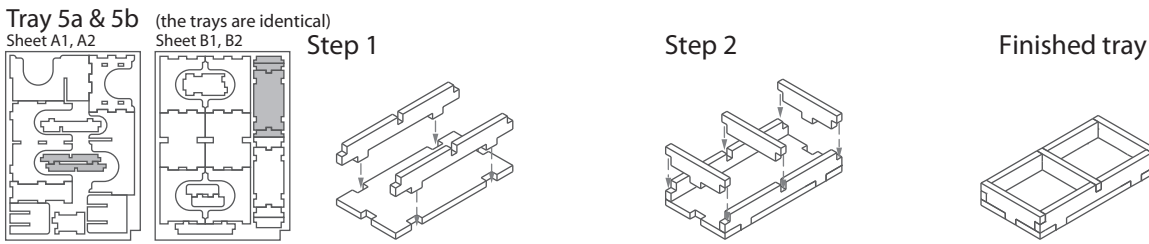
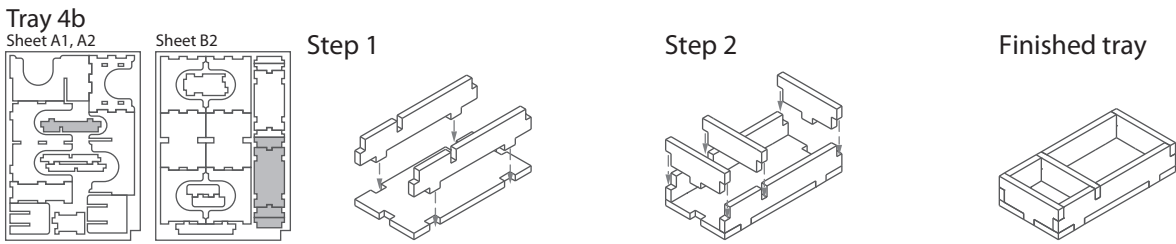
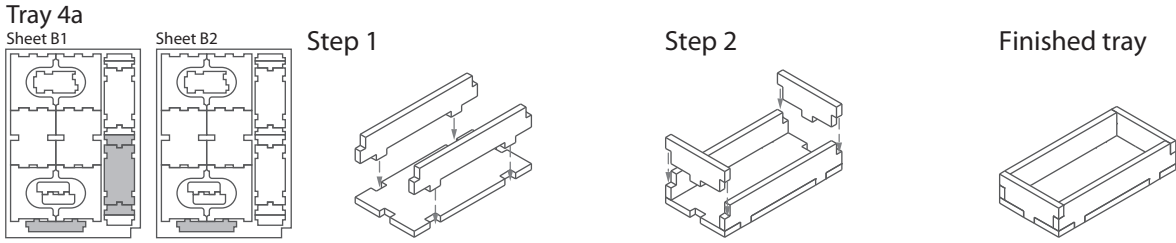
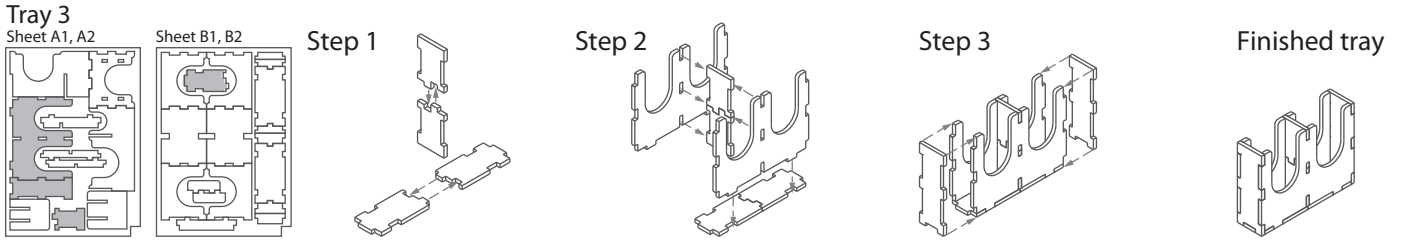

**FS-AEONv2**

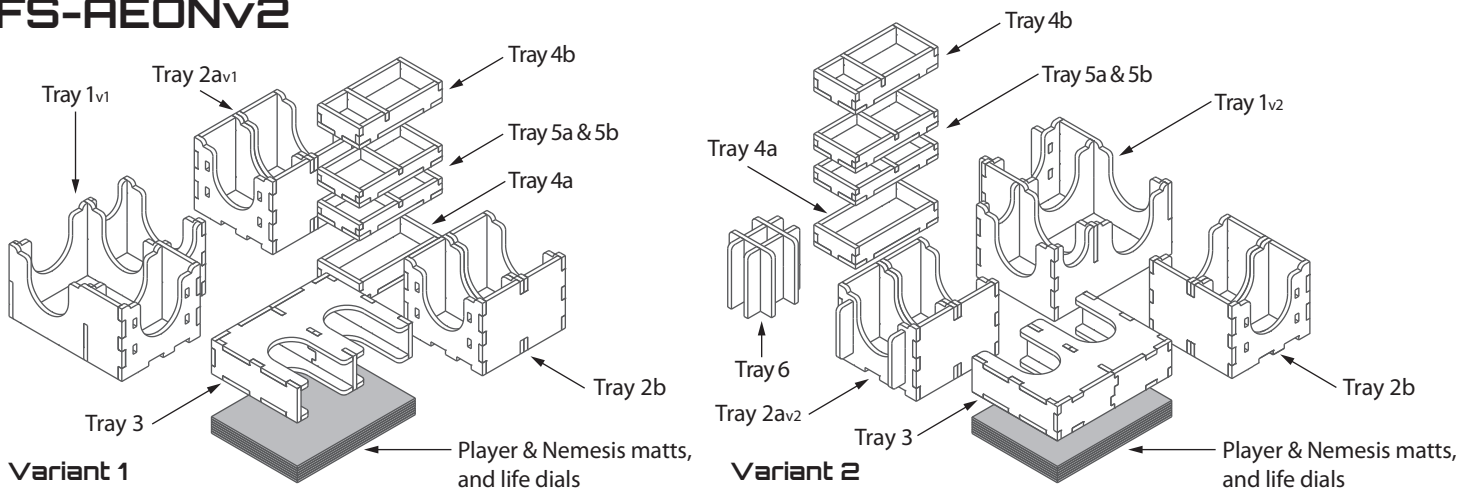

**Tray legend:**

- Tray 1 - breach tiles and other cards
- Tray 2a, b - nemesis, spell and randomizer cards
- Tray 3 - gem cards
- Tray 4a - dice and large tokens
- Tray 4b - plastic gems and other tokens
- Tray 5a - life and other small tokens
- Tray 5b - pulse and fury/husk tokens
- Tray 6 - filler tray for Variant 2

Please check [www.foldedspace.net](http://www.foldedspace.net) for photos of this insert in use.

**Tip:** Keep the instructions in the bottom of your board game box as a reminder of how the insert fits together.