

FS-ROB insert compatible with Robinson Crusoe[®], incl. Voyage of the Beagle Vol. 1[®] expansion.



Assembly Instructions

The package contains 4 sheets, two of them are identical to the other two.

The parts marked in sheets A1, A2, B2 are to be discarded.

After assembly the trays are put in two layers in the original game box.

Ordinary PVA glue is required when assembling each tray.

Please make sure you dry-assemble each tray correctly before gluing it together.

Please check www.foldedspace.net for general assembly tips.

FS-ROB

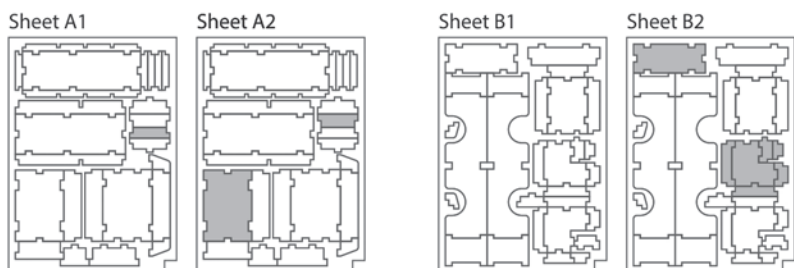
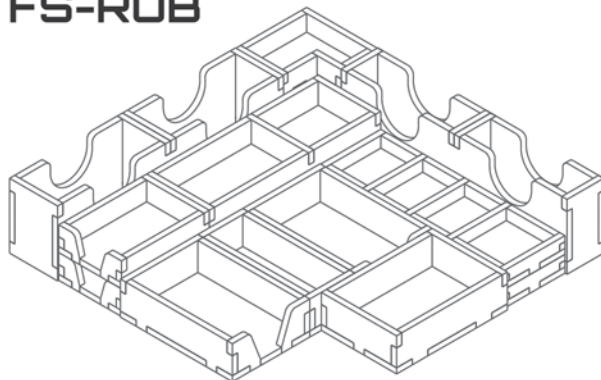

Tray 1a & 1b (the trays are identical)

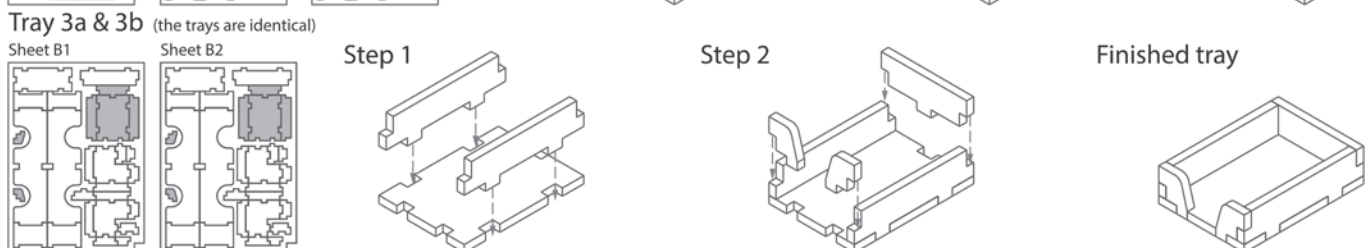
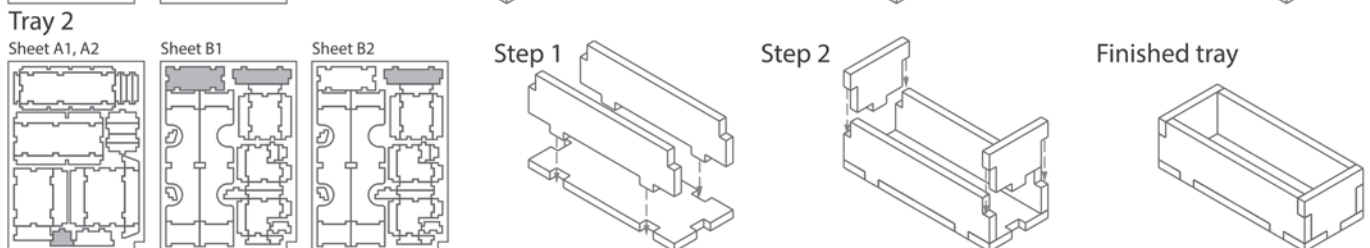
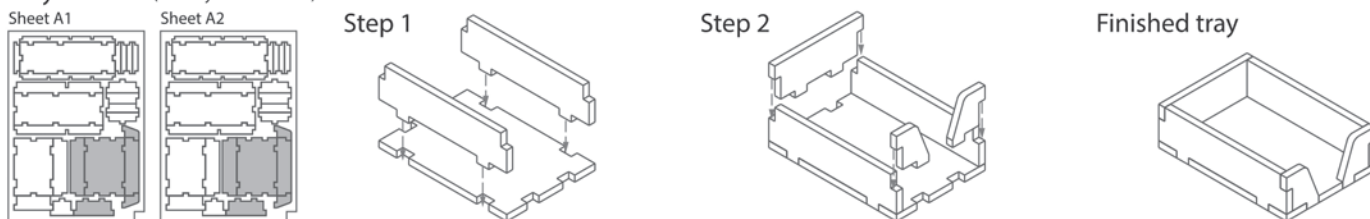

Tray 4a, 4b & 4c (the trays are identical) Note: the three trays are identical, so one base must be inverted. Be sure to dry assemble before applying glue.

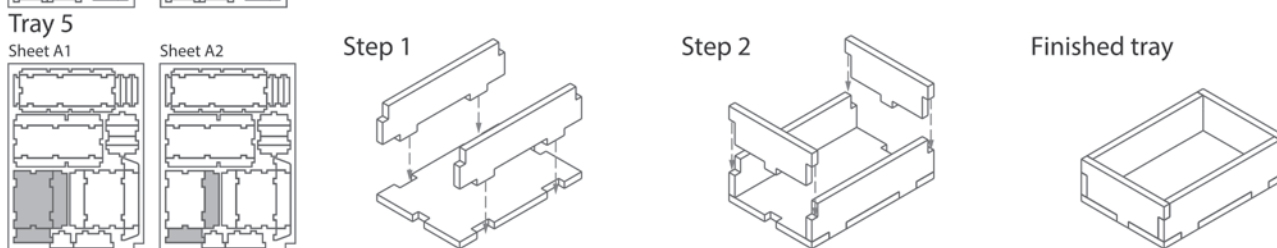
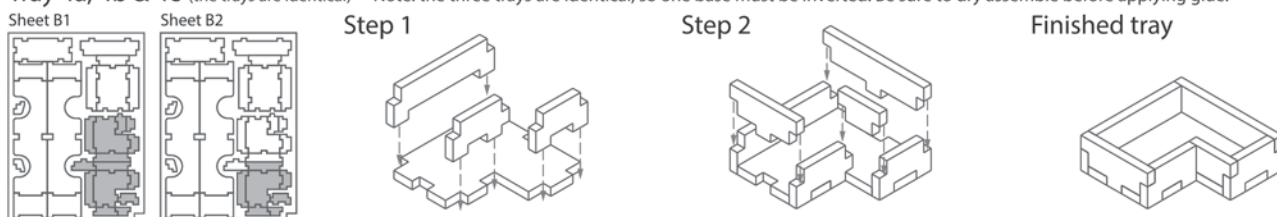

Tray 6a & 6b (the trays are identical)

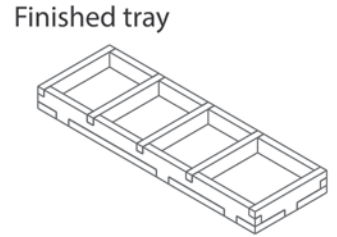
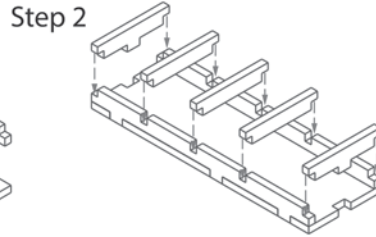
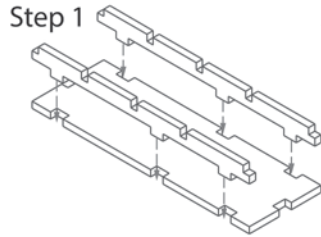
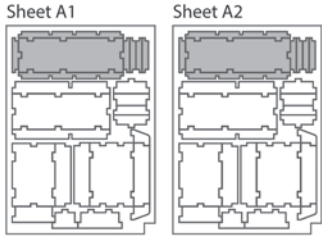

Tray 7a

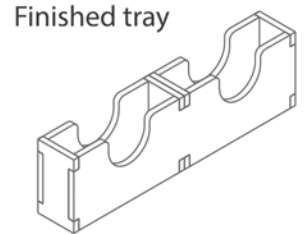
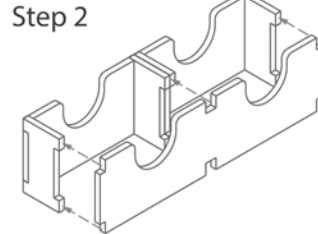
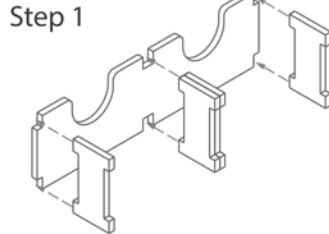
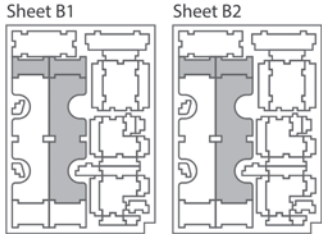

Tray 7b (the tray is wider than Tray 7a)

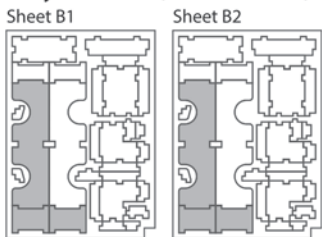

To assemble repeat steps for Tray 7a.

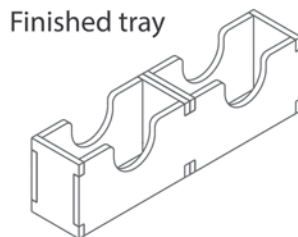

Tray 8a

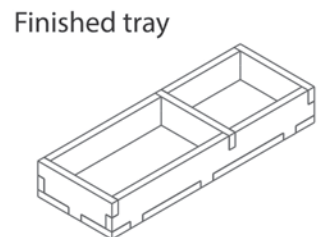
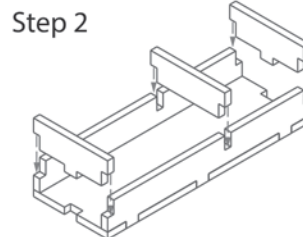
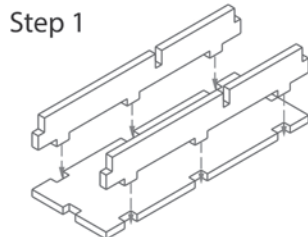
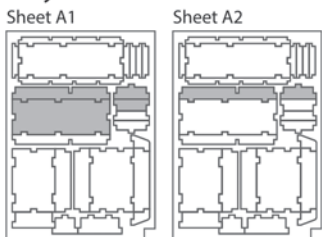

Tray 8b (the tray is lower than Tray 8a)

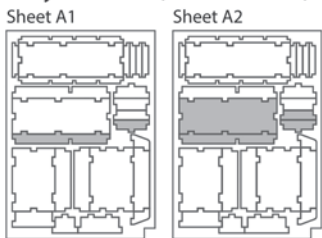

To assemble repeat steps for Tray 8a.

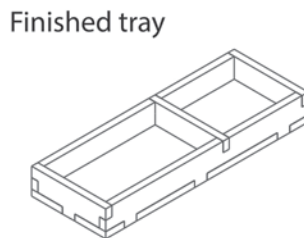

FS-ROB

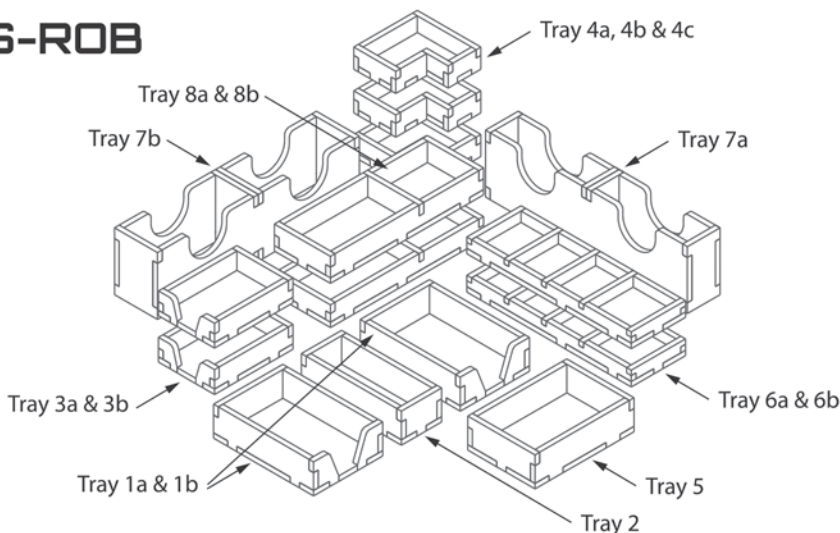

Please check www.foldedspace.net for photos of this insert in use.

Tray legend:

- Tray 1a, b - large cards
 - Tray 2 - discovery tokens
 - Tray 3a, b - small cards
 - Tray 4a - special wound tokens
 - Tray 4b - additional tokens
 - Tray 4c - small beagle tokens
 - Tray 5 - large beagle tokens
 - Tray 6a - resource tokens
 - Tray 6b - coloured markers & other tokens
 - Tray 7a, b - large cards
 - Tray 8a - action pawns
 - Tray 8b - dice & special pawns
- Note: island tiles go in space next to trays 1a & 5